



FORTUNE & COATES

The People's Estate Agent

<https://www.fortuneandcoates.co.uk>



13 Kingfisher Way, Harlow, CM17 0GR

Guide price £260,000

Guide price £260,000-£270,000

Fortune and Coates are pleased to bring to market this outstanding two bedroom first floor apartment on the highly sought after Gilden Park development on the outskirts of Harlow, Essex.

This stylish two double bedroom first floor apartment is stunningly presented throughout and comprises entrance hallway with storage cupboard, open plan lounge/diner/kitchen. The kitchen is done to a high specification and offer a range of wall and base units, integrated oven and hob, stylish work surfaces and splash backs. The lounge area offers space and light with room for a dining table. The two bedrooms are well proportioned with one bedroom featuring fitted wardrobes. The family bathroom is modern with part tiles walls and over bath shower.

Lounge/Kitchen/Diner 21'4" x 13'3" (6.52 x 4.06)

Bedroom 11'7" x 10'11" (3.55 x 3.33)

Bedroom 8'11" x 8'3" (2.72 x 2.52)

AGENT NOTE: The information provided about this property does not constitute or form part of an offer or contract, nor may it be regarded as representations. All interested parties must verify accuracy and your solicitor must verify tenure/lease information, fixtures & fittings and, where the property has been extended/converted, planning/building regulation consents. All dimensions are approximate and quoted for guidance only as are floor plans which are not to scale and their accuracy cannot be confirmed. Reference to appliances and/or services does not imply that they are necessarily in working order or fit for the purpose.

Floor Plan

Kingfisher Way

Approximate Gross Internal Area = 557 sq ft / 51.8 sq m

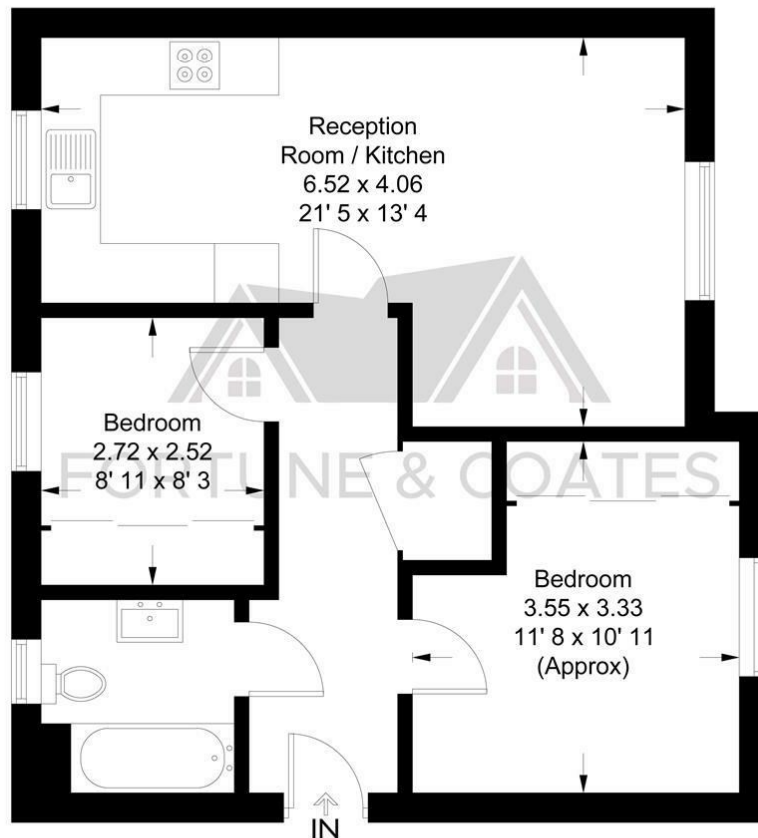

Ground Floor

This plan is not to scale and must be used as layout guidance only. All measurements and areas are approximate and should not be relied upon to provide accurate information. This plan must not be relied upon when making property valuations, design considerations or any other such relevant decisions. We accept no responsibility or liability (whether in contract, tort or otherwise) in relation to any loss whatsoever arising from or in connection with any use of this plan or the adequacy, accuracy or completeness of it or any information within it.

Area Map

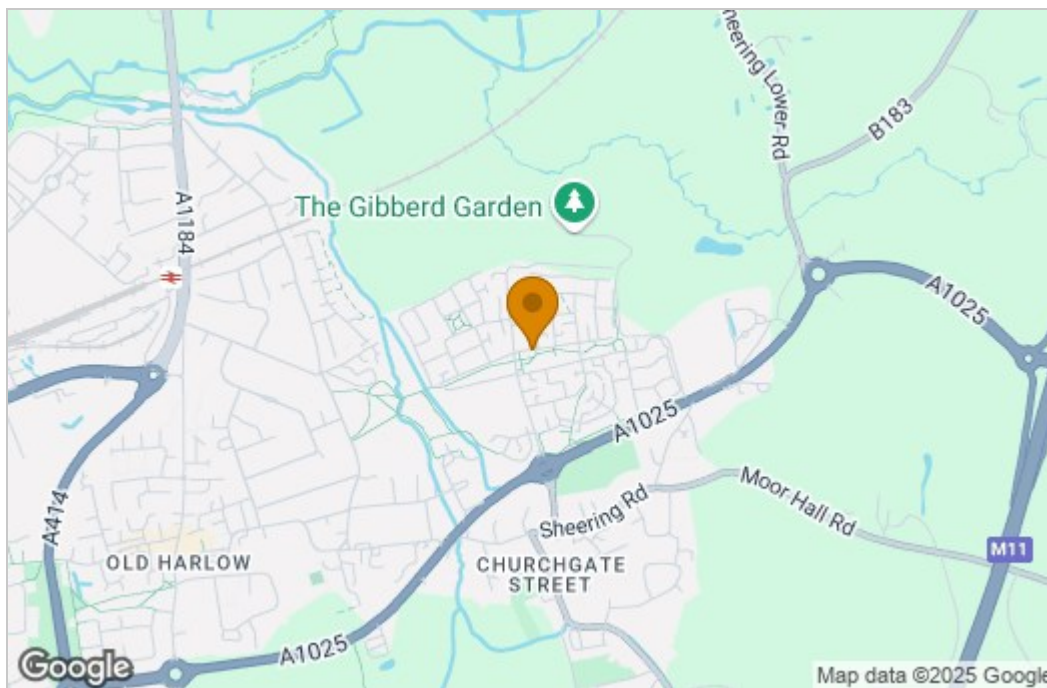

Energy Efficiency Graph

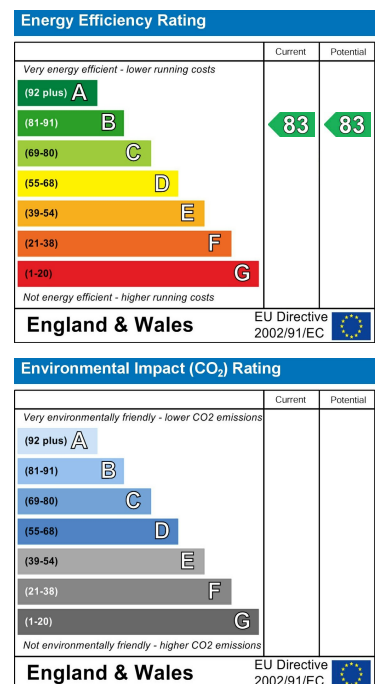

These particulars, whilst believed to be accurate are set out as a general outline only for guidance and do not constitute any part of an offer or contract. Intending purchasers should not rely on them as statements of representation of fact, but must satisfy themselves by inspection or otherwise as to their accuracy. No person in this firm's employment has the authority to make or give any representation or warranty in respect of the property.